**FAG**★ **4206-BB-TVH**

Deep groove ball bearing

Schaeffler ID:
021943460000Deep groove ball bearing 42...BB-TVH,
double row, plastic cage

★ Preferred product

Technical information

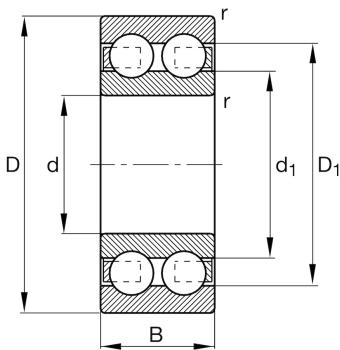

Temperature range

T_{\min}	-20 °C	Operating temperature min.
T_{\max}	120 °C	Operating temperature max.
	0,248 kg	Weight

Main Dimensions & Performance Data

d	30 mm	Bore diameter
D	62 mm	Outside diameter
B	20 mm	Width
C_r	29.000 N	Basic dynamic load rating, radial
C_{0r}	21.600 N	Basic static load rating, radial
C_{ur}	1.130 N	Fatigue load limit, radial
n_G	9.400 1/min	Limiting speed
n_{gr}	9.600 1/min	Reference speed

Dimensions

r_{\min}	1 mm	Minimum chamfer dimension
D_1	51,8 mm	Shoulder diameter outer ring
d_1	39,9 mm	Shoulder diameter inner ring

Mounting dimensions

$d_{a\min}$	35,6 mm	Minimum diameter shaft shoulder
$D_{a\max}$	56,4 mm	Maximum diameter of housing shoulder
$r_{a\max}$	1 mm	Maximum fillet radius

Calculation factors

f_0	14,2	Calculation factor
-------	------	--------------------

