

FAG

★ 607

Deep groove ball bearing

Schaeffler ID:
0383905900000Deep groove ball bearing 60, single row,
steel sheet metal cage

★ Preferred product

Technical information

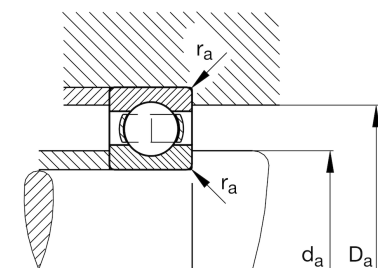
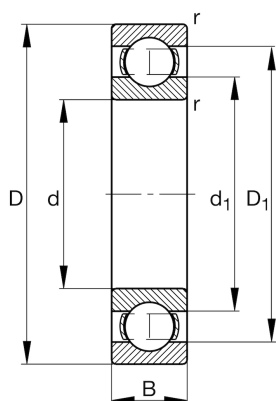

Temperature range

T_{\min}	-30 °C	Operating temperature min.
T_{\max}	120 °C	Operating temperature max.
	8 g	Weight

Main Dimensions & Performance Data

d	7 mm	Bore diameter
D	19 mm	Outside diameter
B	6 mm	Width
C_r	2.340 N	Basic dynamic load rating, radial
C_{0r}	889 N	Basic static load rating, radial
C_{ur}	46,5 N	Fatigue load limit, radial
n_G	45.500 1/min	Limiting speed
n_{gr}	37.000 1/min	Reference speed

Dimensions

r_{\min}	0,3 mm	Minimum chamfer dimension
D_1	15,5 mm	Shoulder diameter outer ring
d_1	10,12 mm	Shoulder diameter inner ring

Mounting dimensions

$d_{a\min}$	9 mm	Minimum diameter shaft shoulder
$D_{a\max}$	17 mm	Maximum diameter of housing shoulder
$r_{a\max}$	0,3 mm	Maximum fillet radius

Calculation factors

f_0	12,1	Calculation factor
-------	------	--------------------