

FAG

★ S6006-2RSR

Deep groove ball bearing

Schaeffler ID:
0539525100000

★ Preferred product

Deep groove ball bearing S60...-2RSR,
corrosion-resistant materials, single row,
seals, steel sheet metal cage

Technical information

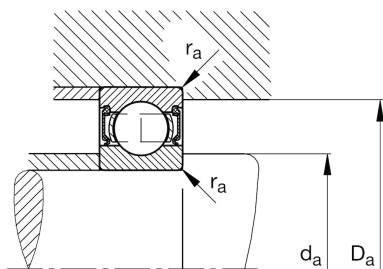
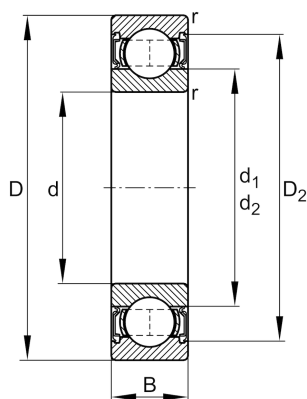

Temperature range

| | | |
|------------|--------|----------------------------|
| T_{\min} | -30 °C | Operating temperature min. |
| T_{\max} | 110 °C | Operating temperature max. |
| | 0,1 kg | Weight |

Main Dimensions & Performance Data

| | | |
|----------|-------------|-----------------------------------|
| d | 30 mm | Bore diameter |
| D | 55 mm | Outside diameter |
| B | 13 mm | Width |
| C_r | 11.120 N | Basic dynamic load rating, radial |
| C_{0r} | 6.620 N | Basic static load rating, radial |
| C_{ur} | 435 N | Fatigue load limit, radial |
| n_G | 7.000 1/min | Limiting speed |

Dimensions

| | | |
|------------|----------|------------------------------|
| r_{\min} | 1 mm | Minimum chamfer dimension |
| D_2 | 49,95 mm | Caliber diameter outer ring |
| d_1 | 38 mm | Shoulder diameter inner ring |

Mounting dimensions

| | | |
|-------------|---------|--------------------------------------|
| $d_{a\min}$ | 34,6 mm | Minimum diameter shaft shoulder |
| $D_{a\max}$ | 50,4 mm | Maximum diameter of housing shoulder |
| $r_{a\max}$ | 1 mm | Maximum fillet radius |

Calculation factors

| | | |
|-------|------|--------------------|
| f_0 | 11,8 | Calculation factor |
|-------|------|--------------------|