

FAG

## ★ 61800-2RSR

Deep groove ball bearing

Schaeffler ID:  
0554514030000Deep groove ball bearing 618...-2RSR,  
single row, seals, steel sheet metal cage

★ Preferred product

## Technical information

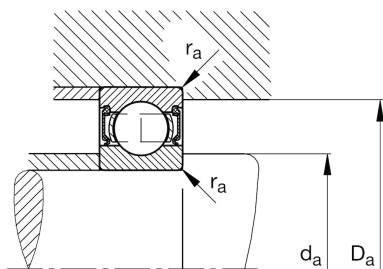
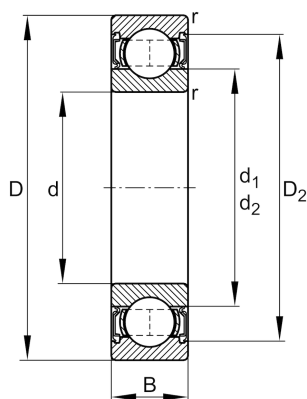

## Temperature range

$T_{\min}$	-30 °C	Operating temperature min.
$T_{\max}$	110 °C	Operating temperature max.
	0,006 kg	Weight

## Main Dimensions &amp; Performance Data

d	10 mm	Bore diameter
D	19 mm	Outside diameter
B	5 mm	Width
$C_r$	1.720 N	Basic dynamic load rating, radial
$C_{0r}$	840 N	Basic static load rating, radial
$C_{ur}$	58 N	Fatigue load limit, radial
$n_G$	21.000 1/min	Limiting speed

## Dimensions

$r_{\min}$	0,3 mm	Minimum chamfer dimension
$D_2$	17,2 mm	Caliber diameter outer ring
$d_2$	11,8 mm	Caliber diameter inner ring

## Mounting dimensions

$d_{a \min}$	12 mm	Minimum diameter shaft shoulder
$D_{a \max}$	17 mm	Maximum diameter of housing shoulder
$r_{a \max}$	0,3 mm	Maximum fillet radius

## Calculation factors

$f_0$	14,8	Calculation factor
-------	------	--------------------