

FAG

★ 61801-2RSR

Deep groove ball bearing

Schaeffler ID:
0554529490000Deep groove ball bearing 618...-2RSR,
single row, seals, steel sheet metal cage

★ Preferred product

Technical information

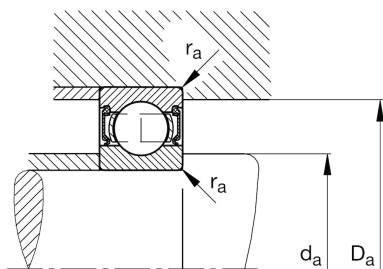
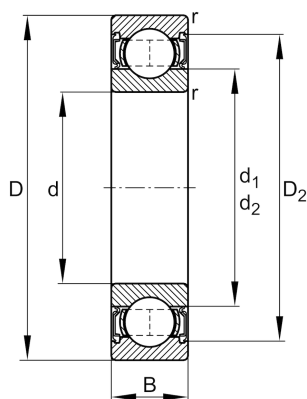

Temperature range

| | | |
|------------|----------|----------------------------|
| T_{\min} | -30 °C | Operating temperature min. |
| T_{\max} | 110 °C | Operating temperature max. |
| | 0,009 kg | Weight |

Main Dimensions & Performance Data

| | | |
|----------|--------------|-----------------------------------|
| d | 12 mm | Bore diameter |
| D | 21 mm | Outside diameter |
| B | 5 mm | Width |
| C_r | 1.920 N | Basic dynamic load rating, radial |
| C_{0r} | 1.040 N | Basic static load rating, radial |
| C_{ur} | 47,5 N | Fatigue load limit, radial |
| n_G | 18.100 1/min | Limiting speed |

Dimensions

| | | |
|------------|---------|-----------------------------|
| r_{\min} | 0,3 mm | Minimum chamfer dimension |
| D_2 | 19,2 mm | Caliber diameter outer ring |
| d_2 | 13,8 mm | Caliber diameter inner ring |

Mounting dimensions

| | | |
|--------------|--------|--------------------------------------|
| $d_{a \min}$ | 14 mm | Minimum diameter shaft shoulder |
| $D_{a \max}$ | 19 mm | Maximum diameter of housing shoulder |
| $r_{a \max}$ | 0,3 mm | Maximum fillet radius |

Calculation factors

| | | |
|-------|------|--------------------|
| f_0 | 15,3 | Calculation factor |
|-------|------|--------------------|