



FAG

★ 61803

Deep groove ball bearing

Schaeffler ID:
0554543130000Deep groove ball bearing 618, single row,
steel sheet metal cage

★ Preferred product

Technical information

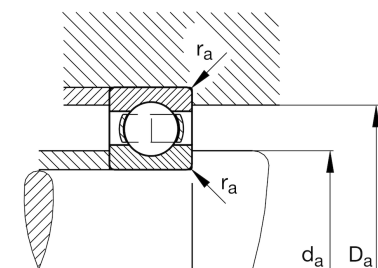
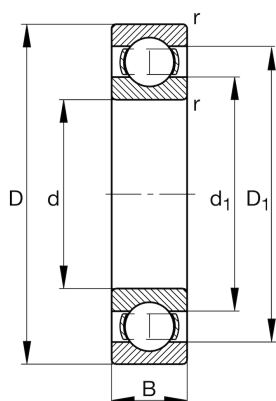

Temperature range

T_{\min}	-30 °C	Operating temperature min.
T_{\max}	120 °C	Operating temperature max.
	8 g	Weight

Main Dimensions & Performance Data

d	17 mm	Bore diameter
D	26 mm	Outside diameter
B	5 mm	Width
C_r	2.230 N	Basic dynamic load rating, radial
C_{0r}	1.460 N	Basic static load rating, radial
C_{ur}	67 N	Fatigue load limit, radial
n_G	41.500 1/min	Limiting speed
n_{gr}	17.100 1/min	Reference speed

Dimensions

r_{\min}	0,3 mm	Minimum chamfer dimension
D_1	23,3 mm	Shoulder diameter outer ring
d_1	19,8 mm	Shoulder diameter inner ring

Mounting dimensions

$d_{a\min}$	19 mm	Minimum diameter shaft shoulder
$D_{a\max}$	24 mm	Maximum diameter of housing shoulder
$r_{a\max}$	0,3 mm	Maximum fillet radius

Calculation factors

f_0	16,1	Calculation factor
-------	------	--------------------