

FAG

## ★ 62200-A-2RSR

Deep groove ball bearing

Schaeffler ID:  
0596140050000Deep groove ball bearing 622..-A-2RSR,  
single row, steel sheet metal cage

★ Preferred product

## Technical information

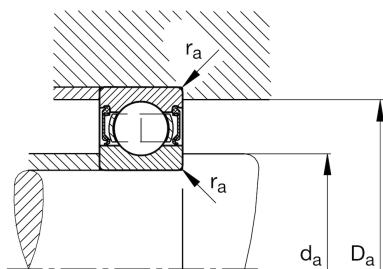
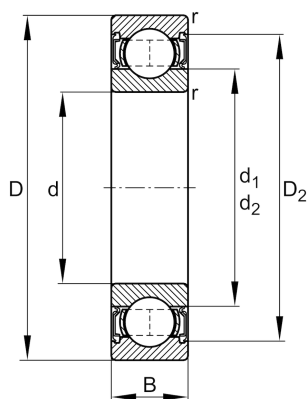

## Temperature range

$T_{\min}$	-20 °C	Operating temperature min.
$T_{\max}$	110 °C	Operating temperature max.
	0,044 kg	Weight

## Main Dimensions &amp; Performance Data

d	10 mm	Bore diameter
D	30 mm	Outside diameter
B	14 mm	Width
$C_r$	6.200 N	Basic dynamic load rating, radial
$C_{0r}$	2.600 N	Basic static load rating, radial
$C_{ur}$	200 N	Fatigue load limit, radial
$n_G$	16.700 1/min	Limiting speed

## Dimensions

$r_{\min}$	0,6 mm	Minimum chamfer dimension
$D_2$	25,8 mm	Caliber diameter outer ring
$d_1$	16 mm	Shoulder diameter inner ring

## Mounting dimensions

$d_{a \min}$	14,2 mm	Minimum diameter shaft shoulder
$D_{a \max}$	25,8 mm	Maximum diameter of housing shoulder
$r_{a \max}$	0,6 mm	Maximum fillet radius

## Calculation factors

$f_0$	12	Calculation factor
-------	----	--------------------