

FAG

## ★ 62205-A-2RSR

Deep groove ball bearing

Schaeffler ID:  
0596569480000Deep groove ball bearing 622..-A-2RSR,  
single row, steel sheet metal cage

★ Preferred product

## Technical information

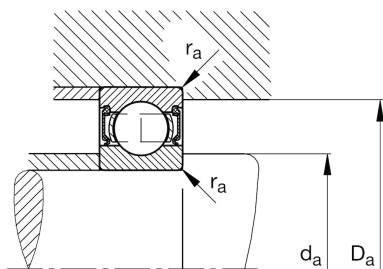
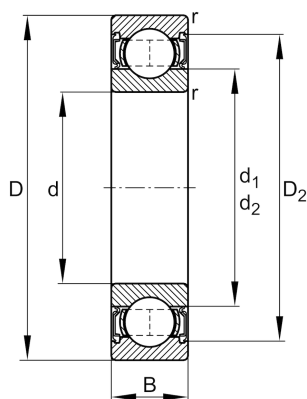

## Temperature range

$T_{\min}$	-20 °C	Operating temperature min.
$T_{\max}$	110 °C	Operating temperature max.
	0,154 kg	Weight

## Main Dimensions &amp; Performance Data

d	25 mm	Bore diameter
D	52 mm	Outside diameter
B	18 mm	Width
$C_r$	14.900 N	Basic dynamic load rating, radial
$C_{0r}$	7.900 N	Basic static load rating, radial
$C_{ur}$	540 N	Fatigue load limit, radial
$n_G$	7.900 1/min	Limiting speed

## Dimensions

$r_{\min}$	1 mm	Minimum chamfer dimension
$D_2$	46,3 mm	Caliber diameter outer ring
$d_1$	31,8 mm	Shoulder diameter inner ring

## Mounting dimensions

$d_{a \min}$	30,6 mm	Minimum diameter shaft shoulder
$D_{a \max}$	46,4 mm	Maximum diameter of housing shoulder
$r_{a \max}$	1 mm	Maximum fillet radius

## Calculation factors

$f_0$	13,9	Calculation factor
-------	------	--------------------