

## Technical information

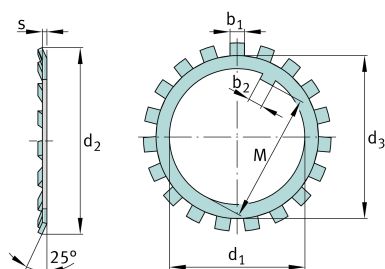

### Main Dimensions & Performance Data

$d_1$	85 mm	bore diameter
$d_2$	119 mm	Outside diameter
$s$	1,75 mm	Thickness
	51 g	Weight

### Dimensions

	100	Counted quantity
--	-----	------------------

### Mounting dimensions

$d_3$	102 mm	Plant diameter outside
$b_2$	10 mm	Distance lug
$M$	81,5 mm	Distance lug
$b_1$	8 mm	Width lock washer tab