

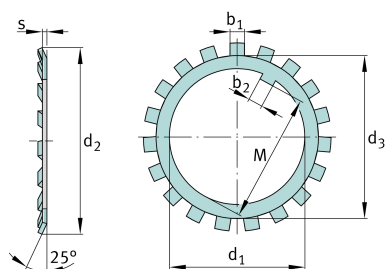

Technical information



Main Dimensions & Performance Data

d_1	180 mm	bore diameter
d_2	242 mm	Outside diameter
s	2,5 mm	Thickness
	0,003 kg	Weight

Dimensions

	100	Counted quantity
--	-----	------------------

Mounting dimensions

d_3	203 mm	Plant diameter outside
b_2	20 mm	Distance lug
M	174 mm	Distance lug
b_1	18 mm	Width lock washer tab