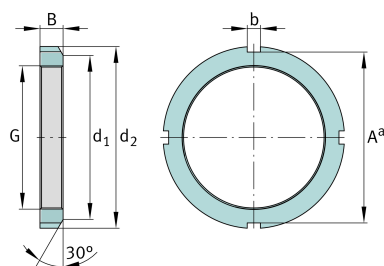
**FAG****KM9**

Locknut

Schaeffler ID:  
0167322000000

Locknuts KM, main dimensions to DIN 981

## Technical information

**Main Dimensions & Performance Data**

G	M45x1,5	Thread
d <sub>2</sub>	65 mm	Outerside diameter
B	10 mm	Width
	0,001 kg	Weight

**Additional information**

F	77.000 N	Axial load capacity, static
	MB9	Fuse
	30 °	Chamfer angle

**Mounting dimensions**

d <sub>1</sub>	56 mm	Chamfer diameter
b	6 mm	Width retaining slot
A <sup>a</sup>	60 mm	Groove base distance