

KML32

Locknut

Schaeffler ID:
0167322270000

Locknuts KML, main dimensions to DIN
981

Technical information

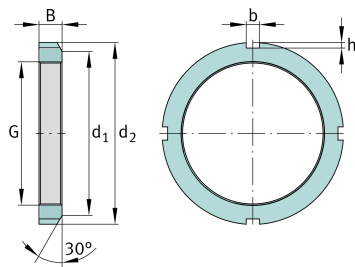

Main Dimensions & Performance Data

G	M160x3	Thread
d 2	190 mm	Outerside diameter
B	25 mm	Width
	1,68 kg	Weight

Additional information

F	520.000 N	Axial load capacity, static
	MBL32	Fuse
	30 °	Chamfer angle

Mounting dimensions

d 1	180 mm	Chamfer diameter
b	14 mm	Width retaining slot
h	5 mm	Hight retaining slot