

FAG

KML38

Locknut

Schaeffler ID:
0167322350000

Locknuts KML, main dimensions to DIN
981

Technical information

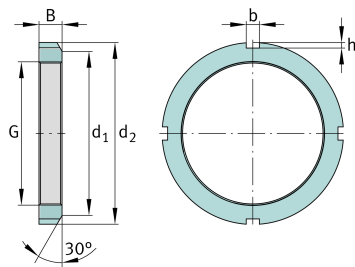

Main Dimensions & Performance Data

G	M190x3	Thread
d 2	220 mm	Outerside diameter
B	28 mm	Width
	2,186 kg	Weight

Additional information

F	650.000 N	Axial load capacity, static
	MBL38	Fuse
	30 °	Chamfer angle

Mounting dimensions

d 1	210 mm	Chamfer diameter
b	16 mm	Width retaining slot
h	5 mm	Hight retaining slot