

FAG

KML40

Locknut

Schaeffler ID:
0192027330000

Locknuts KML, main dimensions to DIN
981

Technical information

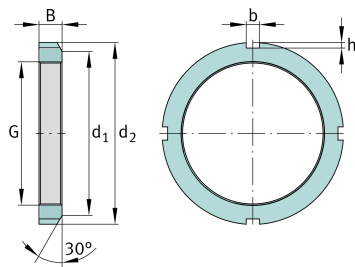

Main Dimensions & Performance Data

G	M200x3	Thread
d 2	240 mm	Outerside diameter
B	29 mm	Width
	3,11 kg	Weight

Additional information

F	800.000 N	Axial load capacity, static
	MBL40	Fuse
	30 °	Chamfer angle

Mounting dimensions

d 1	220 mm	Chamfer diameter
b	18 mm	Width retaining slot
h	8 mm	Hight retaining slot