

★ 81207-TV

Axial cylindrical roller bearing

Schaeffler ID:
0007166930000

Axial cylindrical roller bearings 812, single direction, comprising K812, GS, WS

★ Preferred product

Technical information

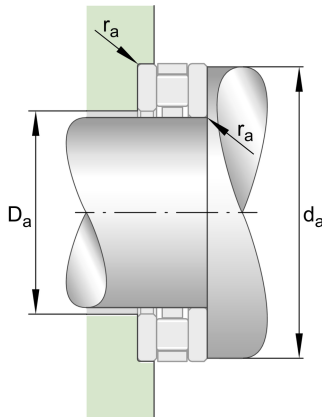
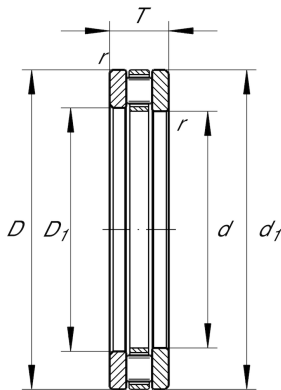

Temperature range

T_{\min}	-30 °C	Operating temperature min.
T_{\max}	120 °C	Operating temperature max.
	0,002 kg	Weight

Main Dimensions & Performance Data

d	35 mm	Bore diameter
D	62 mm	Outside diameter
T	18 mm	Height
C_a	80.000 N	Basic dynamic load rating, axial
C_{0a}	199.000 N	Basic static load rating, axial
C_{ua}	20.400 N	Fatigue load limit, axial
n_G	5.900 1/min	Limiting speed
n_{gr}	2.320 1/min	Reference speed

Dimensions

D_1	37 mm	Bore diameter housing washer
d_1	62 mm	Rip diameter shaft washer
r_{\min}	1 mm	Minimum chamfer dimension

Mounting dimensions

$d_{a \min}$	58 mm	Minimum diameter shaft shoulder
$D_{a \max}$	39 mm	Maximum diameter of housing shoulder
$r_{a \max}$	1 mm	Maximum recess radius

Additional information

K81207-TV	Axial roller and cage assembly
GS81207	Housing Washer
WS81207	Shaft washer
LS7095	Track Washer