

## ★ 81210-TV

Axial cylindrical roller bearing

Schaeffler ID:  
0007167150000

Axial cylindrical roller bearings 812, single direction, comprising K812, GS, WS

★ Preferred product

### Technical information

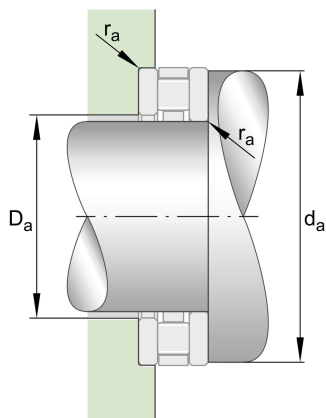
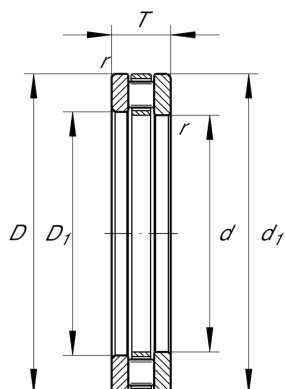

#### Temperature range

$T_{\min}$	-30 °C	Operating temperature min.
$T_{\max}$	120 °C	Operating temperature max.
	0,004 kg	Weight

#### Main Dimensions & Performance Data

d	50 mm	Bore diameter
D	78 mm	Outside diameter
T	22 mm	Height
$C_a$	118.000 N	Basic dynamic load rating, axial
$C_{0a}$	315.000 N	Basic static load rating, axial
$C_{ua}$	28.000 N	Fatigue load limit, axial
$n_G$	4.500 1/min	Limiting speed
$n_{gr}$	1.550 1/min	Reference speed

#### Dimensions

$D_1$	52 mm	Bore diameter housing washer
$d_1$	78 mm	Rip diameter shaft washer
$r_{\min}$	1 mm	Minimum chamfer dimension

#### Mounting dimensions

$d_{a \min}$	75 mm	Minimum diameter shaft shoulder
$D_{a \max}$	53 mm	Maximum diameter of housing shoulder
$r_{a \max}$	1 mm	Maximum recess radius

#### Additional information

K81210-TV	Axial roller and cage assembly
GS81210	Housing Washer
WS81210	Shaft washer
LS7095	Track Washer