

★ 81212-TV

Axial cylindrical roller bearing

Schaeffler ID:
0007167230000

Axial cylindrical roller bearings 812, single direction, comprising K812, GS, WS

★ Preferred product

Technical information

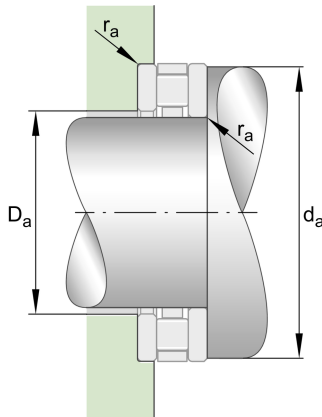
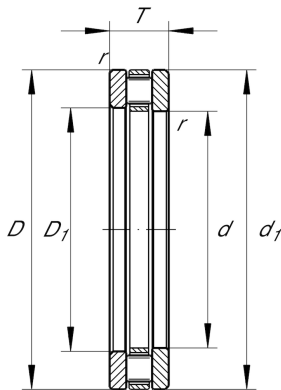

Temperature range

T_{min}	-30 °C	Operating temperature min.
T_{max}	120 °C	Operating temperature max.
	0,642 kg	Weight

Main Dimensions & Performance Data

d	60 mm	Bore diameter
D	95 mm	Outside diameter
T	26 mm	Height
C_a	173.000 N	Basic dynamic load rating, axial
C_{0a}	480.000 N	Basic static load rating, axial
C_{ua}	46.500 N	Fatigue load limit, axial
n_G	3.700 1/min	Limiting speed
n_{gr}	1.300 1/min	Reference speed

Dimensions

D_1	62 mm	Bore diameter housing washer
d_1	95 mm	Rip diameter shaft washer
r_{min}	1 mm	Minimum chamfer dimension

Mounting dimensions

$d_{a min}$	91 mm	Minimum diameter shaft shoulder
$D_{a max}$	64 mm	Maximum diameter of housing shoulder
$r_{a max}$	1 mm	Maximum recess radius

Additional information

K81212-TV	Axial roller and cage assembly
GS81212	Housing Washer
WS81212	Shaft washer
LS7095	Track Washer