



## ★ GE40-XL-KRR-B

Radial insert ball bearing

Schaeffler ID:  
0008049670000

Radial insert ball bearing GE...-XL-KRR-B

★ Preferred product

X-life

### Technical information

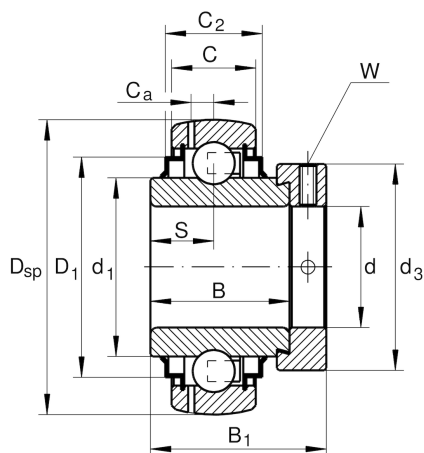

#### Main Dimensions & Performance Data

|                       |              |                                       |
|-----------------------|--------------|---------------------------------------|
| d                     | 40 mm        | Bore diameter                         |
| D <sub>SP</sub>       | 80 mm        | Outside diameter                      |
| B                     | 42,9 mm      | Width                                 |
| B <sub>1</sub>        | 56,5 mm      | Locking collar total width            |
| n <sub>G Grease</sub> | 10.300 1/min | Limiting speed for grease lubrication |
| C <sub>r</sub>        | 32.500 N     | Basic dynamic load rating, radial     |
| C <sub>0r</sub>       | 19.800 N     | Basic static load rating, radial      |
| C <sub>ur</sub>       | 840 N        | Fatigue load limit, radial            |
|                       | 0,73 kg      | Weight                                |

#### Dimensions

|                |         |   |
|----------------|---------|---|
| C              | 21 mm   | Width, outer ring                       |
| C <sub>2</sub> | 23,5 mm | Sealing total width                     |
| S              | 21,4 mm | Distance raceway                        |
| d <sub>1</sub> | 52,3 mm | Rib diameter inner ring                 |
| D <sub>1</sub> | 68,3 mm | Outside diameter seal                   |
| C <sub>a</sub> | 6,4 mm  | Distance to lubrication hole            |
| d <sub>3</sub> | 58 mm   | Outside diameter locking collar/locknut |
| W              | 5 mm    | Width of flats                          |

#### Additional information

|                |      |                    |
|----------------|------|--------------------|
| f <sub>0</sub> | 13,6 | Calculation factor |
|----------------|------|--------------------|