



## GRA108-NPP-B-AS2/V

Radial insert ball bearing

Schaeffler ID:  
0502720980000

Radial insert ball bearing GRA...-NPP-B-  
AS2/V

### Technical information

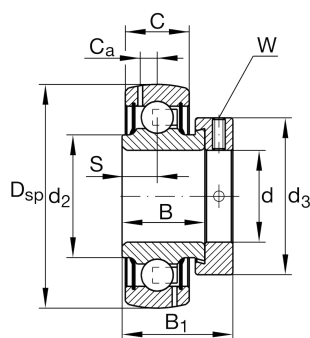

#### Main Dimensions & Performance Data

d	38,1 mm	Bore diameter
d	1.5 inch	Bore diameter, inch
D <sub>SP</sub>	80 mm	Outside diameter
B <sub>1</sub>	43,8 mm	Locking collar total width
B	30,2 mm	Width
C <sub>ur</sub>	910 N	Fatigue load limit, radial
C <sub>r</sub>	32.500 N	Basic dynamic load rating, radial
C <sub>0r</sub>	19.800 N	Basic static load rating, radial
	0,625 kg	Weight

#### Dimensions

C	21 mm	Width, outer ring
S	11 mm	Distance raceway
d <sub>2</sub>	49,3 mm	Rib diameter sealing inner ring
C <sub>a</sub>	6,5 mm	Distance to lubrication hole
d <sub>3</sub>	58 mm	Outside diameter locking collar/locknut
W	0.1875 inch	Width across flats (Inch)

#### Calculation factors

f <sub>0</sub>	13,6	Calculation factor
----------------	------	--------------------