



★ PCFTR20-XL

Flanged housing unit

Schaeffler ID:
0008317860000

Housing units PCFTR, three-bolt flanged housing units, cast iron, eccentric locking collar, P seals

★ Preferred product

X-life

Technical information

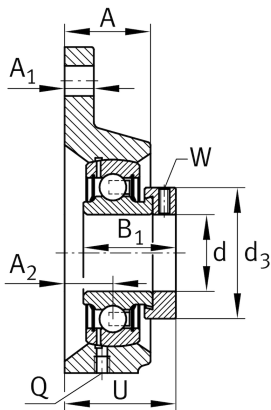
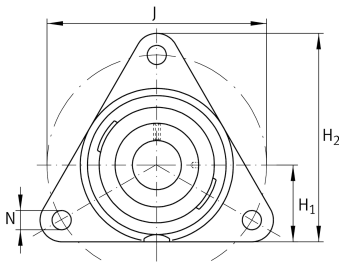

Main Dimensions & Performance Data

| | | |
|-----------------|----------|-----------------------------------|
| d | 20 mm | Bore diameter |
| H ₂ | 92 mm | Height flange |
| U | 34 mm | Total height unit |
| C _r | 13.600 N | Basic dynamic load rating, radial |
| C _{0r} | 6.600 N | Basic static load rating, radial |
| | 0,56 kg | Weight |

Dimensions

| | | |
|----------------|---------|---|
| A | 20 mm | Height housing |
| A ₁ | 11 mm | Thickness of flange |
| A ₂ | 10,5 mm | Distance raceway |
| H ₁ | 35 mm | Distance shaft axis |
| Q | M6 | Connection thread lubrication |
| d ₃ | 33 mm | Outside diameter eccentric locking collar |

Mounting dimensions

| | | |
|---|---------|-------------------------------|
| J | 89,5 mm | Pitch circle diameter (holes) |
| N | 11.5 mm | Fixing bore |
| n | 3 | Number of screwing holes |

Additional information

| | | |
|--|-----------------|---------------------|
| | 1 | Number of housings |
| | CFTR04 | Housing |
| | GRAE20-XL-NPP-B | Bearing designation |