



★ PCFTR25-XL

Flanged housing unit

Schaeffler ID:
0008317940000

★ Preferred product

Housing units PCFTR, three-bolt flanged housing units, cast iron, eccentric locking collar, P seals

X-life

Technical information

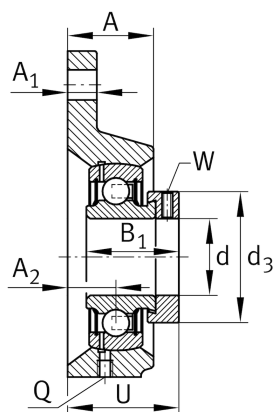
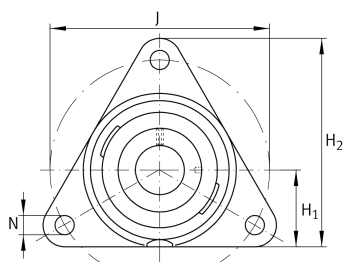

Main Dimensions & Performance Data

d	25 mm	Bore diameter
H ₂	97 mm	Height flange
U	36 mm	Total height unit
C _r	14.900 N	Basic dynamic load rating, radial
C _{0r}	7.800 N	Basic static load rating, radial
	0,614 kg	Weight

Dimensions

A	22 mm	Height housing
A ₁	12 mm	Thickness of flange
A ₂	12,5 mm	Distance raceway
H ₁	36 mm	Distance shaft axis
Q	M6	Connection thread lubrication
d ₃	37,5 mm	Outside diameter eccentric locking collar

Mounting dimensions

J	96 mm	Pitch circle diameter (holes)
N	11.5 mm	Fixing bore
n	3	Number of screwing holes

Additional information

	1	Number of housings
	CFTR05	Housing
	GRAE25-XL-NPP-B	Bearing designation