



★ PCFTR30-XL

Flanged housing unit

Schaeffler ID:
0008318080000

Housing units PCFTR, three-bolt flanged housing units, cast iron, eccentric locking collar, P seals

★ Preferred product

X-life

Technical information

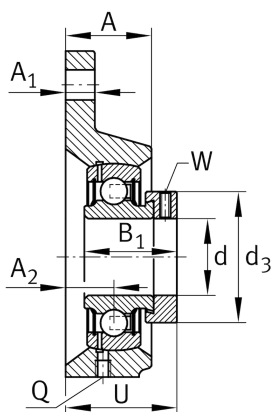
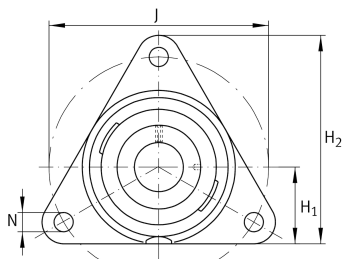

Main Dimensions & Performance Data

d	30 mm	Bore diameter
H ₂	117 mm	Height flange
U	40 mm	Total height unit
C _r	20.700 N	Basic dynamic load rating, radial
C _{0r}	11.300 N	Basic static load rating, radial
	0,99 kg	Weight

Dimensions

A	24 mm	Height housing
A ₁	12 mm	Thickness of flange
A ₂	13,3 mm	Distance raceway
H ₁	44 mm	Distance shaft axis
Q	M6	Connection thread lubrication
d ₃	44 mm	Outside diameter eccentric locking collar

Mounting dimensions

J	116 mm	Pitch circle diameter (holes)
N	11.5 mm	Fixing bore
n	3	Number of screwing holes

Additional information

	1	Number of housings
	CFTR06	Housing
	GRAE30-XL-NPP-B	Bearing designation