



PCFTR45-XL

Flanged housing unit

Schaeffler ID:
0008318320000

Housing units PCFTR, three-bolt flanged housing units, cast iron, eccentric locking collar, P seals

X-life

Technical information

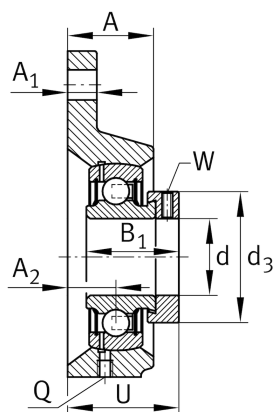
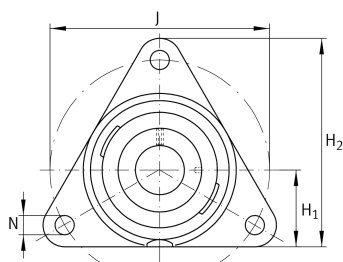

Main Dimensions & Performance Data

d	45 mm	Bore diameter
H ₂	150 mm	Height flange
U	51,9 mm	Total height unit
C _r	34.500 N	Basic dynamic load rating, radial
C _{0r}	20.400 N	Basic static load rating, radial
	2,07 kg	Weight

Dimensions

A	33 mm	Height housing
	1	Number of housings
A ₁	16 mm	Thickness of flange
A ₂	19,2 mm	Distance raceway
	CFTR09	Housing
H ₁	55 mm	Distance shaft axis
	GRAE45-XL-NPP-B	Bearing designation
Q	M6	Connection thread lubrication
d ₃	63 mm	Outside diameter eccentric locking collar

Mounting dimensions

J	160 mm	Pitch circle diameter (holes)
N	14 mm	Fixing bore
n	3	Number of screwing holes