



★ PCFTR50-XL

Flanged housing unit

Schaeffler ID:
0008318400000

★ Preferred product

Housing units PCFTR, three-bolt flanged housing units, cast iron, eccentric locking collar, P seals

X-life

Technical information

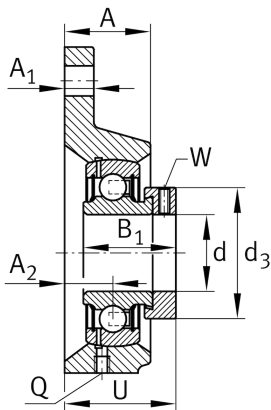
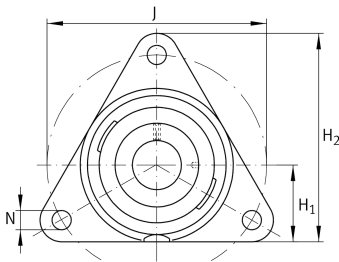

Main Dimensions & Performance Data

d	50 mm	Bore diameter
H ₂	150 mm	Height flange
U	51,9 mm	Total height unit
C _r	37.500 N	Basic dynamic load rating, radial
C _{0r}	23.200 N	Basic static load rating, radial
	2,03 kg	Weight

Dimensions

A	33 mm	Height housing
A ₁	16 mm	Thickness of flange
A ₂	19,2 mm	Distance raceway
H ₁	55 mm	Distance shaft axis
Q	M6	Connection thread lubrication
d ₃	69 mm	Outside diameter eccentric locking collar

Mounting dimensions

J	160 mm	Pitch circle diameter (holes)
N	14 mm	Fixing bore
n	3	Number of screwing holes

Additional information

	1	Number of housings
	CFTR10	Housing
	GRAE50-XL-NPP-B	Bearing designation