

## ★ LR5000-2RS

Track roller

Schaeffler ID:  
0008167100000

Track rollers LR50, double row, sealed on both sides

★ Preferred product

### Technical information

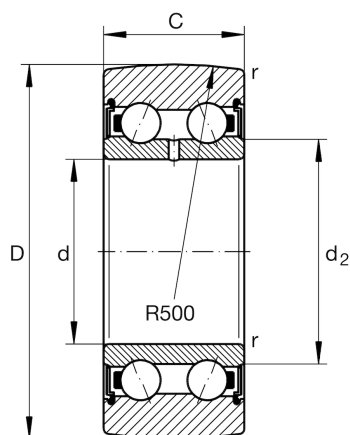

#### Main Dimensions & Performance Data

D	28 mm	Outside diameter
d	10 mm	Bore diameter
C	12 mm	Height
$C_{r w}$	4.750 N	Basic dynamic load rating, radial
$C_{0r w}$	2.950 N	Basic static load rating, radial
$C_{ur w}$	149 N	Fatigue load limit, radial
$n_{DG}$	9.000 1/min	Speed on permanent grease lubrication
$F_{r per}$	2.950 N	Permissible dynamic load outer ring, radial
	0,03 kg	Weight

#### Dimensions

$d_2$	13,5 mm	Diameter of thrust washer
$r_{min}$	0,3 mm	Minimum chamfer dimension
R	500 mm	Radius of outer ring outside profile