

FAG

**6218-M**

Deep groove ball bearing

Schaeffler ID:  
0191056060000Deep groove ball bearing 62..-M, single  
row, solid brass cage

## Technical information

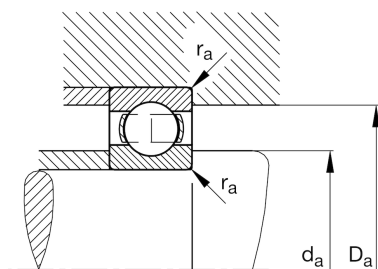
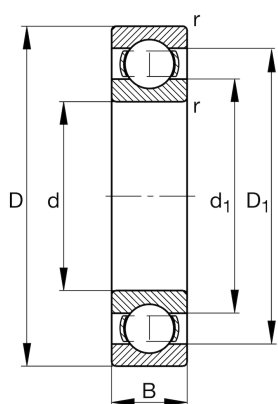
**Main Dimensions & Performance Data**

d	90 mm	Bore diameter
D	160 mm	Outside diameter
B	30 mm	Width
$C_r$	102.000 N	Basic dynamic load rating, radial
$C_{0r}$	74.000 N	Basic static load rating, radial
$C_{ur}$	4.500 N	Fatigue load limit, radial
$n_G$	8.200 1/min	Limiting speed
$n_{gr}$	5.100 1/min	Reference speed
	2,68 kg	Weight

**Dimensions**

$r_{min}$	2 mm	Minimum chamfer dimension
$D_1$	139,2 mm	Shoulder diameter outer ring
$d_1$	112,6 mm	Shoulder diameter inner ring

**Mounting dimensions**

$d_{a min}$	101 mm	Minimum diameter shaft shoulder
$D_{a max}$	149 mm	Maximum diameter of housing shoulder
$r_{a max}$	2 mm	Maximum fillet radius

**Calculation factors**

$f_0$	14,6	Calculation factor
-------	------	--------------------

**Temperature range**

$T_{min}$	-30 °C	Operating temperature min.
$T_{max}$	150 °C	Operating temperature max.