

FAG

6221-M

Deep groove ball bearing

Schaeffler ID:
0385348350000Deep groove ball bearing 62..-M, single
row, solid brass cage

Technical information

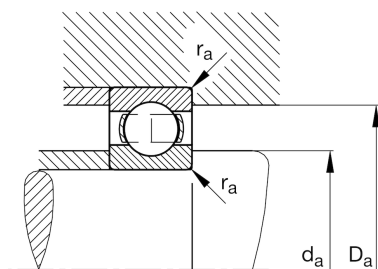
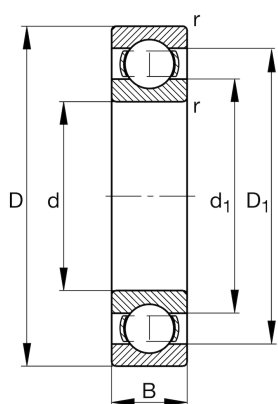
**Main Dimensions & Performance Data**

d	105 mm	Bore diameter
D	190 mm	Outside diameter
B	36 mm	Width
C_r	141.000 N	Basic dynamic load rating, radial
C_{0r}	105.000 N	Basic static load rating, radial
C_{ur}	5.800 N	Fatigue load limit, radial
n_G	6.100 1/min	Limiting speed
n_{gr}	4.650 1/min	Reference speed
	4,58 kg	Weight

Dimensions

r_{min}	2,1 mm	Minimum chamfer dimension
D_1	163,2 mm	Shoulder diameter outer ring
d_1	131,5 mm	Shoulder diameter inner ring

Mounting dimensions

$d_{a min}$	117 mm	Minimum diameter shaft shoulder
$D_{a max}$	178 mm	Maximum diameter of housing shoulder
$r_{a max}$	2,1 mm	Maximum fillet radius

Calculation factors

f_0	14,4	Calculation factor
-------	------	--------------------

Temperature range

T_{min}	-30 °C	Operating temperature min.
T_{max}	150 °C	Operating temperature max.