

## KNO16-B

### Linear ball bearing

Schaeffler ID:  
0296807350000

Linear ball bearings KNO..-B, Lightweight range, open design, with relubrication facility, adjustable angle

## Technical information

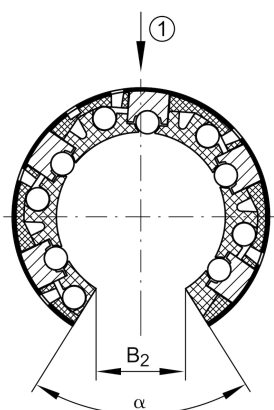
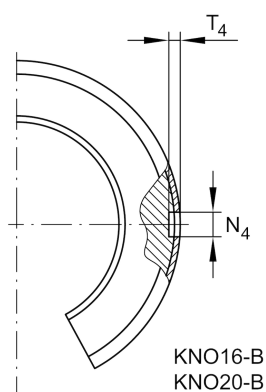

### Main Dimensions & Performance Data

$F_w$	16 mm	Bore diameter of ball complement
$D$	26 mm	Outside diameter
$L$	36 mm	length
$C_{max}$	1.000 N	load capacity dyn.
$C_{0max}$	750 N	load capacity stat.
	20 g	Weight

### Mounting dimensions

$B_2$	9 mm	Width of sector opening
$T_4$	0,7 mm	
$N_4$	3 mm	
$\alpha$	68 °	Angle of sector opening
$b_{1max}$	1,5 mm	
	4	Number of rows balls

