

## ★ E70-XL-KRR

Radial insert ball bearing

Schaeffler ID:  
0008805310000

★ Preferred product

Radial insert ball bearings E..-KRR, cylindrical outer ring, location by eccentric locking collar, R seals on both sides

X-life

### Technical information

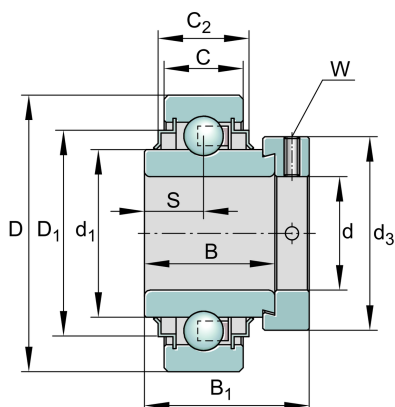

### Main Dimensions & Performance Data

|                 |          |                                   |
|-----------------|----------|-----------------------------------|
| d               | 70 mm    | Bore diameter                     |
| D               | 125 mm   | Outside diameter                  |
| B               | 48,5 mm  | Width                             |
| B <sub>1</sub>  | 66 mm    | Locking collar total width        |
| C <sub>r</sub>  | 66.000 N | Basic dynamic load rating, radial |
| C <sub>0r</sub> | 44.000 N | Basic static load rating, radial  |
| C <sub>ur</sub> | 2.300 N  | Fatigue load limit, radial        |
|                 | 2,12 kg  | Weight                            |

### Dimensions

|                |         |   |
|----------------|---------|---|
| C              | 28 mm   | Width, outer ring                       |
| C <sub>2</sub> | 32 mm   | Sealing total width                     |
| S              | 21,5 mm | Distance raceway                        |
| d <sub>1</sub> | 85,2 mm | Rib diameter inner ring                 |
| D <sub>1</sub> | 109 mm  | Outside diameter seal                   |
| d <sub>3</sub> | 96 mm   | Outside diameter locking collar/locknut |
| W              | 6 mm    | Width of flats                          |

### Calculation factors

|                |      |                    |
|----------------|------|--------------------|
| f <sub>0</sub> | 14,4 | Calculation factor |
|----------------|------|--------------------|