



★ RCJO35-XL

Flanged housing unit

Schaeffler ID:
0008990890000

★ Preferred product

Housing units RCJO, four-bolt flanged housing units, cast iron, eccentric locking collar, series 63, R seals

X-life

Technical information

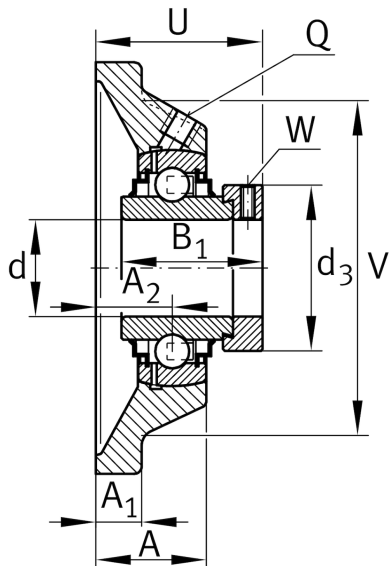
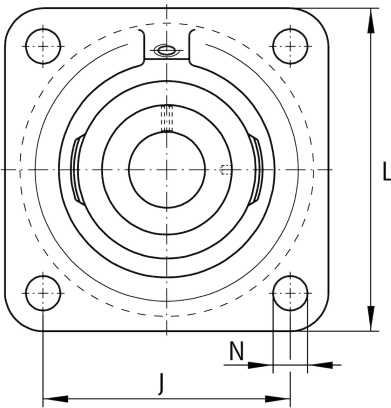

Main Dimensions & Performance Data

d	35 mm	Bore diameter
L	135 mm	Flange width
U	53,4 mm	Total height unit
C_r	36.500 N	Basic dynamic load rating, radial
C_{0r}	20.900 N	Basic static load rating, radial
C_{ur}	1.090 N	Fatigue load limit, radial
	2,55 kg	Weight

Dimensions

A	31 mm	Height housing
A_1	16 mm	Thickness of flange
A_2	20 mm	Distance raceway
V	104 mm	Shoulder diameter housing
Q	M6	Connection thread lubrication
d_3	55 mm	Outside diameter eccentric locking collar

Mounting dimensions

J	100 mm	Distance fixing bore
N	19 mm	Fixing bore
n	4	Number of screwing holes

Additional information

	1	Number of housings
	CJO07	Housing
	GNE35-XL-KRR-B	Bearing designation