

TASE65-214-XL
Plummer block housing unit

Schaeffler ID:
0009792010000

Plummer block housing units TASE, cast iron housing, radial insert ball bearing with eccentric locking collar, T seals



Technical information

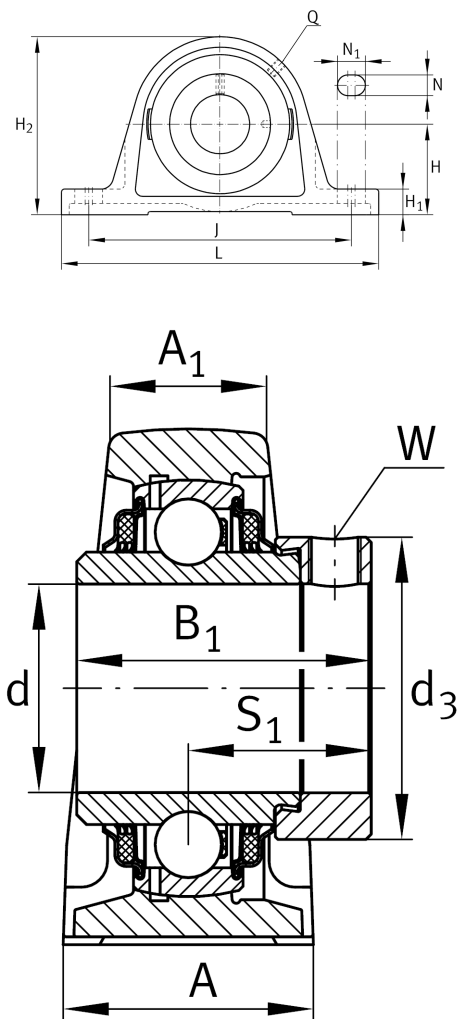

Main Dimensions & Performance Data

d	65 mm	Bore diameter
L	260 mm	Length total
H ₂	156 mm	Height
	6,49 kg	Weight

Dimensions

H	79,4 mm	Distance shaft axis
A	65 mm	Width (base)
A ₁	44 mm	Width (head)
H ₁	27,5 mm	Height (base)
B ₁	66 mm	Locking collar total width
S ₁	44,5 mm	Distance of raceway to locking collar
Q	M6	Connection thread lubrication

Mounting dimensions

J	202,5 mm	Distance fixing bore
N	22 mm	Width (slot)
N ₁	28 mm	Length (slot)

Additional information

ASE14	Housing
GE65-214-XL-KTT-B	Bearing designation