

★ NATR10

Yoke type track roller

Schaeffler ID:
0005794160000

Yoke type track rollers NATR, with axial guidance, gap seals on both sides

★ Preferred product

Technical information

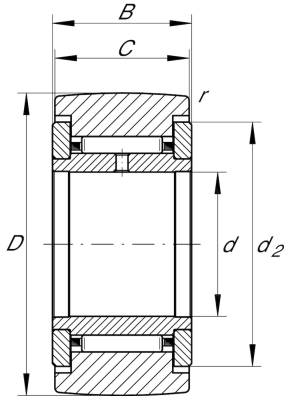

Main Dimensions & Performance Data

d	10 mm	Bore diameter
D	30 mm	Outside diameter
B	15 mm	Width, inner ring
$C_{r w}$	6.800 N	Basic dynamic load rating, radial
$C_{0r w}$	8.700 N	Basic static load rating, radial
$C_{ur w}$	1.240 N	Fatigue load limit, radial
n_{DG}	5.500 1/min	Speed on permanent grease lubrication
$F_{0r per}$	8.700 N	Permissible static load, radial
$F_{r per}$	8.700 N	Permissible dynamic load outer ring, radial
	0,128 kg	Weight

Dimensions

C	14 mm	Width, outer ring
d_2	23 mm	Outside diameter of thrust washer
r_{min}	0,6 mm	Minimum chamfer dimension
R	500 mm	Radius of outer ring outside profile