

★ NATR5

Yoke type track roller

Schaeffler ID:
0000318010000

Yoke type track rollers NATR, with axial guidance, gap seals on both sides

★ Preferred product

Technical information

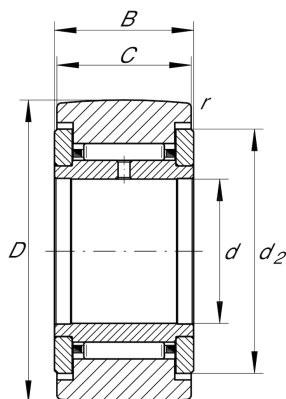

Main Dimensions & Performance Data

d	5 mm	Bore diameter
D	16 mm	Outside diameter
B	12 mm	Width, inner ring
$C_{r w}$	3.150 N	Basic dynamic load rating, radial
$C_{0r w}$	3.400 N	Basic static load rating, radial
$C_{ur w}$	460 N	Fatigue load limit, radial
n_{DG}	14.000 1/min	Speed on permanent grease lubrication
$F_{0r per}$	3.400 N	Permissible static load, radial
$F_{r per}$	3.400 N	Permissible dynamic load outer ring, radial
	15,1 g	Weight

Dimensions

C	11 mm	Width, outer ring
d_2	12,5 mm	Outside diameter of thrust washer
r_{min}	0,15 mm	Minimum chamfer dimension
R	500 mm	Radius of outer ring outside profile