

## ★ NATR6

### Yoke type track roller

Schaeffler ID:  
0000318280000

Yoke type track rollers NATR, with axial guidance, gap seals on both sides

★ Preferred product

## Technical information

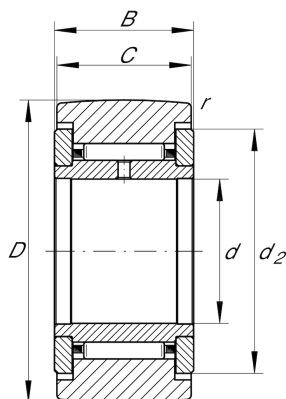

### Main Dimensions & Performance Data

d	6 mm	Bore diameter
D	19 mm	Outside diameter
B	12 mm	Width, inner ring
$C_{r w}$	3.500 N	Basic dynamic load rating, radial
$C_{0r w}$	4.050 N	Basic static load rating, radial
$C_{ur w}$	550 N	Fatigue load limit, radial
$n_{DG}$	11.000 1/min	Speed on permanent grease lubrication
$F_{0r per}$	4.050 N	Permissible static load, radial
$F_{r per}$	4.050 N	Permissible dynamic load outer ring, radial
	0,02 kg	Weight

### Dimensions

C	11 mm	Width, outer ring
$d_2$	15 mm	Outside diameter of thrust washer
$r_{min}$	0,15 mm	Minimum chamfer dimension
R	500 mm	Radius of outer ring outside profile