



## ★ NATR25

Yoke type track roller

Schaeffler ID:  
0000319680000

Yoke type track rollers NATR, with axial  
guidance, gap seals on both sides

★ Preferred product

### Technical information

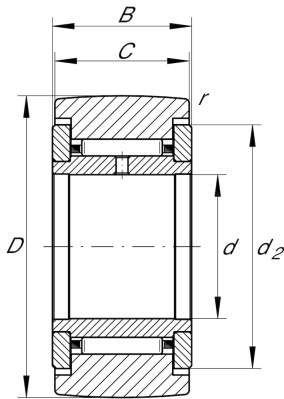

### Main Dimensions & Performance Data

$d$	25 mm	Bore diameter
$D$	52 mm	Outside diameter
$B$	25 mm	Width, inner ring
$C_{r w}$	15.300 N	Basic dynamic load rating, radial
$C_{0r w}$	27.000 N	Basic static load rating, radial
$C_{ur w}$	3.600 N	Fatigue load limit, radial
$n_{DG}$	1.800 1/min	Speed on permanent grease lubrication
$F_{0r per}$	27.000 N	Permissible static load, radial
$F_{r per}$	27.000 N	Permissible dynamic load outer ring, radial
	0,286 kg	Weight

### Dimensions

$C$	24 mm	Width, outer ring
$d_2$	41,5 mm	Outside diameter of thrust washer
$r_{min}$	1 mm	Minimum chamfer dimension
$R$	500 mm	Radius of outer ring outside profile