

## ★ NATR15

Yoke type track roller

Schaeffler ID:  
0005796370000

Yoke type track rollers NATR, with axial guidance, gap seals on both sides

★ Preferred product

### Technical information

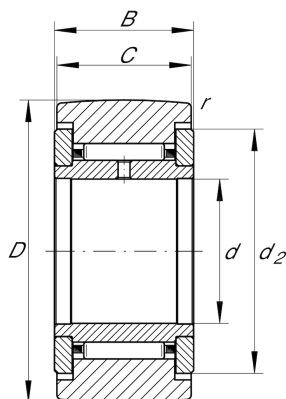

#### Main Dimensions & Performance Data

d	15 mm	Bore diameter
D	35 mm	Outside diameter
B	19 mm	Width, inner ring
$C_{r w}$	9.700 N	Basic dynamic load rating, radial
$C_{0r w}$	14.500 N	Basic static load rating, radial
$C_{ur w}$	1.860 N	Fatigue load limit, radial
$n_{DG}$	3.600 1/min	Speed on permanent grease lubrication
$F_{0r per}$	14.500 N	Permissible static load, radial
$F_{r per}$	14.500 N	Permissible dynamic load outer ring, radial
	0,102 kg	Weight

#### Dimensions

C	18 mm	Width, outer ring
$d_2$	27,6 mm	Outside diameter of thrust washer
$r_{min}$	0,6 mm	Minimum chamfer dimension
R	500 mm	Radius of outer ring outside profile