

★ **NATR12**

Yoke type track roller

Schaeffler ID:  
0005813480000

★ Preferred product

Yoke type track rollers NATR, with axial guidance, gap seals on both sides

Technical information

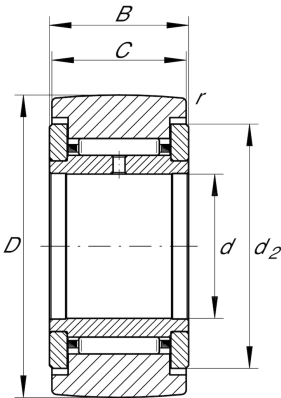

Main Dimensions & Performance Data

d	12 mm	Bore diameter
D	32 mm	Outside diameter
B	15 mm	Width, inner ring
C <sub>r w</sub>	7.000 N	Basic dynamic load rating, radial
C <sub>0r w</sub>	9.200 N	Basic static load rating, radial
C <sub>ur w</sub>	1.320 N	Fatigue load limit, radial
n <sub>D G</sub>	4.500 1/min	Speed on permanent grease lubrication
F <sub>0r per</sub>	9.200 N	Permissible static load, radial
F <sub>r per</sub>	9.200 N	Permissible dynamic load outer ring, radial
	70,667 g	Weight

Dimensions

C	14 mm	Width, outer ring
d <sub>2</sub>	25 mm	Outside diameter of thrust washer
r <sub>min</sub>	0,6 mm	Minimum chamfer dimension
R	500 mm	Radius of outer ring outside profile