



★ NUKRE40

Yoke type track roller

Schaeffler ID:
0031403000000

★ Preferred product

Stud type track rollers NUKRE, with axial guidance, full complement cylindrical roller set, with eccentric collar, labyrinth seals on both sides

Technical information

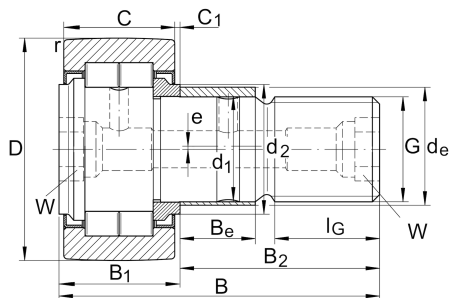

Main Dimensions & Performance Data

D	40 mm	Outside diameter
d_1	18 mm	Fit diameter of roller stud / stud
B	58 mm	Width
C_{rw}	18.800 N	Basic dynamic load rating, radial
C_{0rw}	25.500 N	Basic static load rating, radial
C_{urw}	3.250 N	Fatigue load limit, radial
n_{DG}	5.500 1/min	Speed on permanent grease lubrication
F_{0rper}	25.500 N	Permissible static load, radial
F_{rper}	12.900 N	Permissible dynamic load outer ring, radial
	0,263 kg	Weight

Dimensions

B_1	24,6 mm	Maximum width of thrust washer
B_2	33,5 mm	Bolt/stud length effectively
C	20 mm	Width, outer ring
C_1	3,8 mm	Protrusion outer ring to thrust washer
r_{min}	1 mm	Minimum chamfer dimension
d_2	30 mm	Stop diameter of thrust washer
G	M18X1,5	Thread
l_G	19 mm	Thread length
W	8 mm	Width of flats
d_e	22 mm	Diameter of eccentric
B_e	14 mm	Width, eccentric
e	1 mm	Eccentricity

Additional information

	NIPA2X7,5	Drive-fit lubrication nipple
M_A	87 Nm	Tightening torque nut