

★ KR80-PP

Yoke type track roller

Schaeffler ID:
0055831440000

★ Preferred product

Stud type track rollers KR...-PP, with axial guidance, plastic axial plain washers on both sides, optimized INA-profile

Technical information

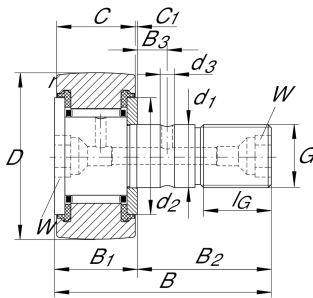

Main Dimensions & Performance Data

D	80 mm	Outside diameter
d ₁	30 mm	Fit diameter of roller stud / stud
B	100 mm	Width
C _{r w}	38.500 N	Basic dynamic load rating, radial
C _{0r w}	78.000 N	Basic static load rating, radial
C _{ur w}	11.200 N	Fatigue load limit, radial
n _{D G}	1.300 1/min	Speed on permanent grease lubrication
	1,58 kg	Weight

Dimensions

B ₁	37 mm	Maximum width of thrust washer
B ₂	63 mm	Bolt/stud length effectively
B ₃	15 mm	Distance to lubrication hole
C	35 mm	Width, outer ring
C ₁	1 mm	Protrusion outer ring to thrust washer
r _{min}	1,1 mm	Minimum chamfer dimension
d ₂	53 mm	Stop diameter of thrust washer
d ₃	4 mm	Diameter lubrication hole
G	M30X1,5	Thread
l _G	32 mm	Thread length
W	14 mm	Width of flats

Additional information

	NIPA3X9,5	Drive-fit lubrication nipple
M _A	450 Nm	Tightening torque nut