

★ KRE40-PP

Yoke type track roller

Schaeffler ID:
0055916190000

★ Preferred product

Stud type track rollers KRE...-PP, with axial guidance, with eccentric collar, plastic axial plain washers on both sides

Technical information

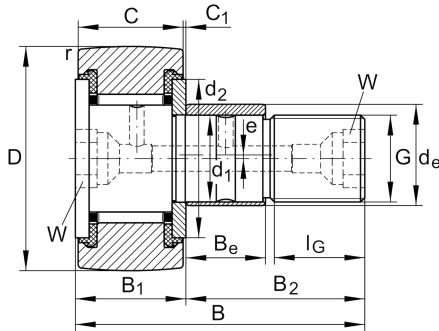

Main Dimensions & Performance Data

D	40 mm	Outside diameter
d_1	18 mm	Fit diameter of roller stud / stud
B	58 mm	Width
C_{rw}	10.900 N	Basic dynamic load rating, radial
C_{orw}	16.000 N	Basic static load rating, radial
C_{urw}	2.130 N	Fatigue load limit, radial
n_{DG}	2.900 1/min	Speed on permanent grease lubrication
	0,002 kg	Weight

Dimensions

B_1	21,6 mm	Width of thrust washer
B_2	36,5 mm	Bolt/stud length effectively
B_3	8 mm	Distance to lubrication hole
C	20 mm	Width, outer ring
C_1	0,8 mm	Protrusion outer ring to thrust washer
r_{min}	1 mm	Minimum chamfer dimension
d_2	31,5 mm	Stop diameter of thrust washer
d_3	3 mm	Diameter lubrication hole
G	M18X1,5	Thread
l_G	19 mm	Thread length
W	8 mm	Nominal dimension for hexagonal socket
d_e	22 mm	Diameter of eccentric
B_e	16 mm	Width, eccentric
e	1 mm	Eccentricity

Additional information

	NIPA2X7,5	Drive-fit lubrication nipple
M_A	87 Nm	Tightening torque nut