

## ★ KR35

## Yoke type track roller

Schaeffler ID:  
0055921350000

Yoke type track roller KR...-B, with cage,  
with axial guidance, no eccentric

★ Preferred product

## Technical information

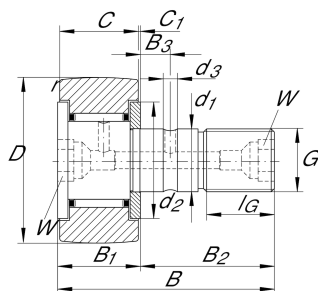

## Main Dimensions &amp; Performance Data

D	35 mm	Outside diameter
d <sub>1</sub>	16 mm	Fit diameter of roller stud / stud
B	52 mm	Width
C <sub>r w</sub>	9.700 N	Basic dynamic load rating, radial
C <sub>0r w</sub>	14.500 N	Basic static load rating, radial
C <sub>ur w</sub>	1.860 N	Fatigue load limit, radial
n <sub>D G</sub>	3.600 1/min	Speed on permanent grease lubrication
	0,163 kg	Weight

## Dimensions

B <sub>1</sub>	19,6 mm	Maximum width of thrust washer
B <sub>2</sub>	32,5 mm	Bolt/stud length effectively
B <sub>3</sub>	8 mm	Distance to lubrication hole
C	18 mm	Width, outer ring
C <sub>1</sub>	0,8 mm	Protrusion outer ring to thrust washer
r <sub>min</sub>	0,6 mm	Minimum chamfer dimension
d <sub>2</sub>	27,6 mm	Stop diameter of thrust washer
d <sub>3</sub>	3 mm	Diameter lubrication hole
G	M16X1,5	Thread
l <sub>G</sub>	17 mm	Thread length
W	8 mm	Width of flats
R	500 mm	Radius of outer ring outside profile

## Additional information

	NIPA2X7,5	Drive-fit lubrication nipple
M <sub>A</sub>	58 Nm	Tightening torque nut