

★ KRE32-PP

Yoke type track roller

Schaeffler ID:
0055923210000

★ Preferred product

Stud type track rollers KRE...-PP, with axial guidance, with eccentric collar, plastic axial plain washers on both sides

Technical information

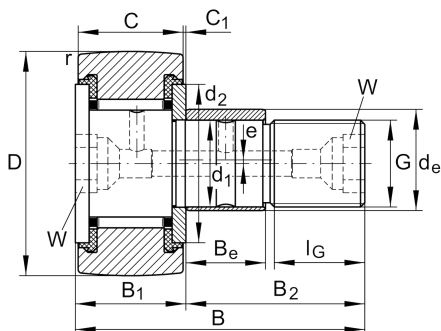

Main Dimensions & Performance Data

D	32 mm	Outside diameter
d ₁	12 mm	Fit diameter of roller stud / stud
B	40 mm	Width
C _{r w}	7.100 N	Basic dynamic load rating, radial
C _{0r w}	9.300 N	Basic static load rating, radial
C _{ur w}	1.320 N	Fatigue load limit, radial
n _{D G}	5.500 1/min	Speed on permanent grease lubrication
	0,099 kg	Weight

Dimensions

B ₁	15,2 mm	Width of thrust washer
B ₂	25 mm	Bolt/stud length effectively
B ₃	6 mm	Distance to lubrication hole
C	14 mm	Width, outer ring
C ₁	0,6 mm	Protrusion outer ring to thrust washer
r _{min}	0,6 mm	Minimum chamfer dimension
d ₂	23 mm	Stop diameter of thrust washer
d ₃	3 mm	Diameter lubrication hole
G	M12X1,5	Thread
l _G	13 mm	Thread length
W	6 mm	Nominal dimension for hexagonal socket
d _e	15 mm	Diameter of eccentric
B _e	11 mm	Width, eccentric
e	0,5 mm	Eccentricity

Additional information

	NIPA1X4,5	Drive-fit lubrication nipple
M _A	22 Nm	Tightening torque nut