

★ KRE62-PP

Yoke type track roller

Schaeffler ID:
0055975870000

★ Preferred product

Stud type track rollers KRE...-PP, with axial guidance, with eccentric collar, plastic axial plain washers on both sides

Technical information

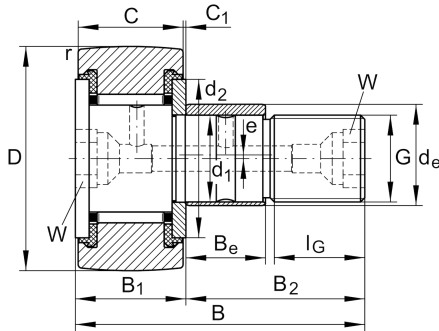

Main Dimensions & Performance Data

D	62 mm	Outside diameter
d ₁	24 mm	Fit diameter of roller stud / stud
B	80 mm	Width
C _{r w}	26.000 N	Basic dynamic load rating, radial
C _{0r w}	48.500 N	Basic static load rating, radial
C _{ur w}	7.000 N	Fatigue load limit, radial
n _{DG}	1.900 1/min	Speed on permanent grease lubrication
	0,784 kg	Weight

Dimensions

B ₁	30,6 mm	Width of thrust washer
B ₂	49,5 mm	Bolt/stud length effectively
B ₃	11 mm	Distance to lubrication hole
C	29 mm	Width, outer ring
C ₁	0,8 mm	Protrusion outer ring to thrust washer
r _{min}	1 mm	Minimum chamfer dimension
d ₂	44 mm	Stop diameter of thrust washer
d ₃	4 mm	Diameter lubrication hole
G	M24X1,5	Thread
l _G	25 mm	Thread length
W	14 mm	Nominal dimension for hexagonal socket
d _e	28 mm	Diameter of eccentric
B _e	22 mm	Width, eccentric
e	1 mm	Eccentricity

Additional information

	NIPA3X9,5	Drive-fit lubrication nipple
M _A	220 Nm	Tightening torque nut