

## ★ KR22

## Yoke type track roller

Schaeffler ID:  
0057442370000

Yoke type track roller KR...-B, with cage,  
with axial guidance, no eccentric

★ Preferred product

## Technical information

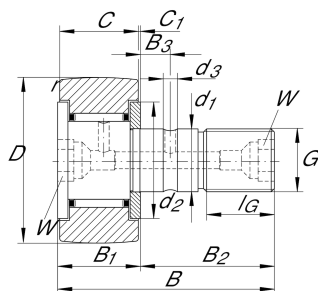

## Main Dimensions &amp; Performance Data

D	22 mm	Outside diameter
d <sub>1</sub>	10 mm	Fit diameter of roller stud / stud
B	36 mm	Width
C <sub>r w</sub>	4.550 N	Basic dynamic load rating, radial
C <sub>0r w</sub>	5.400 N	Basic static load rating, radial
C <sub>ur w</sub>	740 N	Fatigue load limit, radial
n <sub>D G</sub>	8.000 1/min	Speed on permanent grease lubrication
	42,884 g	Weight

## Dimensions

B <sub>1</sub>	13,2 mm	Maximum width of thrust washer
B <sub>2</sub>	23 mm	Bolt/stud length effectively
C	12 mm	Width, outer ring
C <sub>1</sub>	0,6 mm	Protrusion outer ring to thrust washer
r <sub>min</sub>	0,3 mm	Minimum chamfer dimension
d <sub>2</sub>	17,5 mm	Stop diameter of thrust washer
G	M10X1	Thread
l <sub>G</sub>	12 mm	Thread length
W	5 mm	Width of flats
R	500 mm	Radius of outer ring outside profile

## Additional information

	NIPA1X4,5	Drive-fit lubrication nipple
M <sub>A</sub>	15 Nm	Tightening torque nut