

## ★ KRE22-PP

### Yoke type track roller

Schaeffler ID:  
0057462050000

★ Preferred product

Stud type track rollers KRE...-PP, with axial guidance, with eccentric collar, plastic axial plain washers on both sides

## Technical information

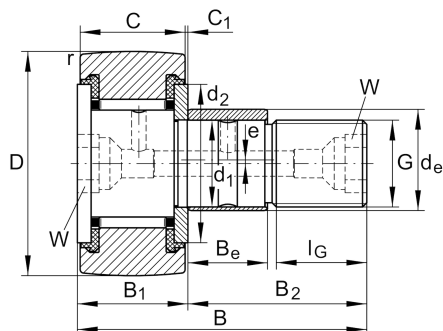

### Main Dimensions & Performance Data

D	22 mm	Outside diameter
$d_1$	10 mm	Fit diameter of roller stud / stud
B	36 mm	Width
$C_{rw}$	4.550 N	Basic dynamic load rating, radial
$C_{orw}$	5.400 N	Basic static load rating, radial
$C_{urw}$	740 N	Fatigue load limit, radial
$n_{DG}$	8.000 1/min	Speed on permanent grease lubrication
	44,919 g	Weight

### Dimensions

$B_1$	13,2 mm	Width of thrust washer
$B_2$	23 mm	Bolt/stud length effectively
C	12 mm	Width, outer ring
$C_1$	0,6 mm	Protrusion outer ring to thrust washer
$r_{min}$	0,3 mm	Minimum chamfer dimension
$d_2$	17,5 mm	Stop diameter of thrust washer
G	M10X1	Thread
$l_G$	12 mm	Thread length
W	5 mm	Nominal dimension for hexagonal socket
$d_e$	13 mm	Diameter of eccentric
$B_e$	10 mm	Width, eccentric
e	0,5 mm	Eccentricity

### Additional information

	NIPA1X4,5	Drive-fit lubrication nipple
$M_A$	15 Nm	Tightening torque nut