

★ KRE52-PP

Yoke type track roller

Schaeffler ID:
0057507410000

★ Preferred product

Stud type track rollers KRE...-PP, with axial guidance, with eccentric collar, plastic axial plain washers on both sides

Technical information

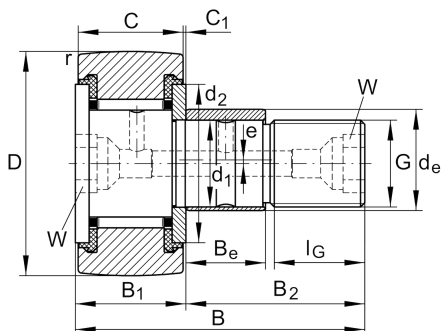

Main Dimensions & Performance Data

D	52 mm	Outside diameter
d ₁	20 mm	Fit diameter of roller stud / stud
B	66 mm	Width
C _{r w}	16.600 N	Basic dynamic load rating, radial
C _{0r w}	29.500 N	Basic static load rating, radial
C _{ur w}	3.850 N	Fatigue load limit, radial
n _{DG}	2.400 1/min	Speed on permanent grease lubrication
	0,49 kg	Weight

Dimensions

B ₁	25,6 mm	Width of thrust washer
B ₂	40,5 mm	Bolt/stud length effectively
B ₃	9 mm	Distance to lubrication hole
C	24 mm	Width, outer ring
C ₁	0,8 mm	Protrusion outer ring to thrust washer
r _{min}	1 mm	Minimum chamfer dimension
d ₂	36,5 mm	Stop diameter of thrust washer
d ₃	4 mm	Diameter lubrication hole
G	M20X1,5	Thread
l _G	21 mm	Thread length
W	10 mm	Nominal dimension for hexagonal socket
d _e	24 mm	Diameter of eccentric
B _e	18 mm	Width, eccentric
e	1 mm	Eccentricity

Additional information

	NIPA2X7,5	Drive-fit lubrication nipple
M _A	120 Nm	Tightening torque nut