

★ NUKRE80

Yoke type track roller

Schaeffler ID:
0096690000000

★ Preferred product

Stud type track rollers NUKRE, with axial guidance, full complement cylindrical roller set, with eccentric collar, labyrinth seals on both sides

Technical information

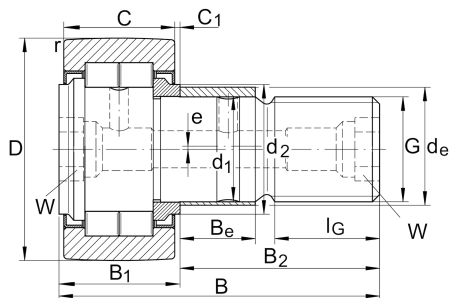

Main Dimensions & Performance Data

| | | |
|--------------|-------------|---|
| D | 80 mm | Outside diameter |
| d_1 | 30 mm | Fit diameter of roller stud / stud |
| B | 100 mm | Width |
| $C_{r w}$ | 69.000 N | Basic dynamic load rating, radial |
| $C_{0r w}$ | 105.000 N | Basic static load rating, radial |
| $C_{ur w}$ | 14.300 N | Fatigue load limit, radial |
| $n_{D G}$ | 1.800 1/min | Speed on permanent grease lubrication |
| $F_{0r per}$ | 94.000 N | Permissible static load, radial |
| $F_{r per}$ | 47.000 N | Permissible dynamic load outer ring, radial |
| | 1,65 kg | Weight |

Dimensions

| | | |
|-----------|---------|--|
| B_1 | 37 mm | Maximum width of thrust washer |
| B_2 | 63 mm | Bolt/stud length effectively |
| C | 35 mm | Width, outer ring |
| C_1 | 1 mm | Protrusion outer ring to thrust washer |
| r_{min} | 1,1 mm | Minimum chamfer dimension |
| d_2 | 47 mm | Stop diameter of thrust washer |
| G | M30X1,5 | Thread |
| l_G | 32 mm | Thread length |
| W | 14 mm | Width of flats |
| d_e | 35 mm | Diameter of eccentric |
| B_e | 29 mm | Width, eccentric |
| e | 1,5 mm | Eccentricity |

Additional information

| | | |
|-------|-----------|------------------------------|
| | NIPA3X9,5 | Drive-fit lubrication nipple |
| M_A | 450 Nm | Tightening torque nut |