



★ PCFTR40-XL

Flanged housing unit

Schaeffler ID:
0008318240000

Housing units PCFTR, three-bolt flanged housing units, cast iron, eccentric locking collar, P seals

★ Preferred product

X-life

Technical information

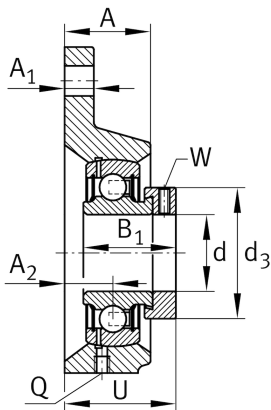
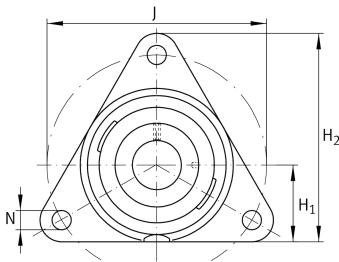

Main Dimensions & Performance Data

d	40 mm	Bore diameter
H ₂	137 mm	Height flange
U	51 mm	Total height unit
C _r	32.500 N	Basic dynamic load rating, radial
C _{0r}	19.800 N	Basic static load rating, radial
	1,67 kg	Weight

Dimensions

A	30 mm	Height housing
A ₁	16 mm	Thickness of flange
A ₂	18,3 mm	Distance raceway
H ₁	51 mm	Distance shaft axis
Q	M6	Connection thread lubrication
d ₃	58 mm	Outside diameter eccentric locking collar

Mounting dimensions

J	140 mm	Pitch circle diameter (holes)
N	14 mm	Fixing bore
n	3	Number of screwing holes

Additional information

	1	Number of housings
	CFTR08	Housing
	GRAE40-XL-NPP-B	Bearing designation