



★ RAY25-XL

Flanged housing unit

Schaeffler ID:
0008329600000

★ Preferred product

Housing units RAY, three/four-bolt flanged housing units, sheet steel, grub screws in inner ring, P seals

X-life

Technical information

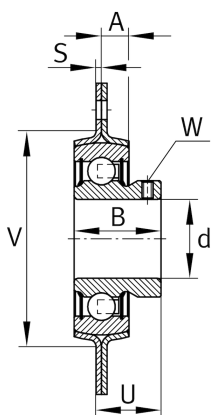

Main Dimensions & Performance Data

d	25 mm	Bore diameter
H	95 mm	Height flange
H	95 mm	Flange width
U	21,5 mm	Total height unit
C_r	14.000 N	Basic dynamic load rating, radial
C_{0r}	7.800 N	Basic static load rating, radial
C_{0rG}	3.650 N	Load carrying capacity (housing)
	0,31 kg	Weight

Dimensions

A	8,7 mm	Height housing
B	27 mm	Width
S	2 mm	Thickness of flange
V	60 mm	Shoulder diameter housing

Mounting dimensions

J	76 mm	Pitch circle diameter (holes)
N	8,7 mm	Fixing square
n	3	Number of screwing holes

Additional information

	2	Number of housings
	FLAN52-MSB	Housing
	AY25-XL-NPP-B	Bearing designation

