



## ★ PTUE50-XL

Take-up housing unit

Schaeffler ID:  
0008561690000

★ Preferred product

Take-up housing units PTUE, cast iron housing, radial insert ball bearing with eccentric locking collar, P seals

X-life

### Technical information

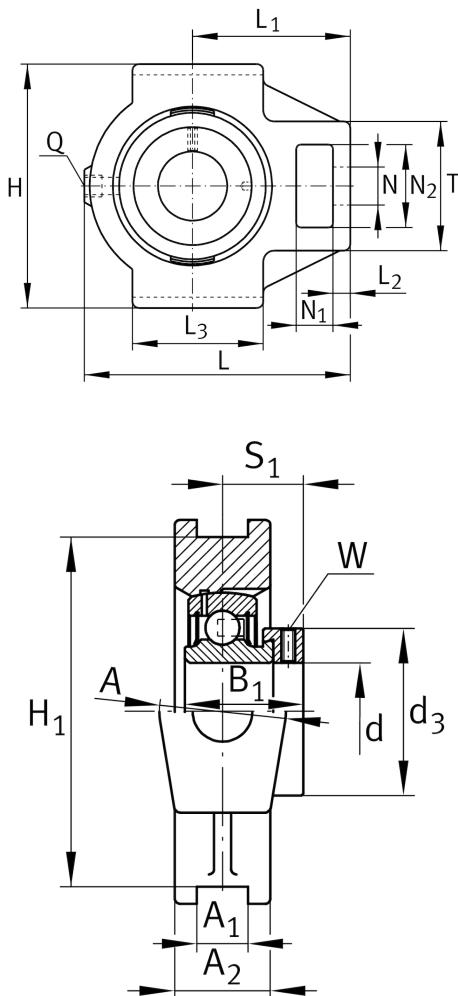

### Main Dimensions & Performance Data

d	50 mm	Bore diameter
H	115 mm	Height
L	148 mm	Length total
	2,35 kg	Weight

### Dimensions

L <sub>1</sub>	90 mm	Distance shaft axis
L <sub>2</sub>	16 mm	Length fixed link
L <sub>3</sub>	85 mm	Length guidance groove
A	50 mm	Width housing fixing side
N <sub>1</sub>	20 mm	Width recess
N <sub>2</sub>	49 mm	Height recess
T	83 mm	Height housing fixing side
Q	Rp1/8	Connection thread lubrication
A <sub>2</sub>	35 mm	Width housing

### Mounting dimensions

A <sub>1</sub>	16 mm	Width guidance groove
	H13	Width guidance groove clearance
H <sub>1</sub>	102 mm	Distance guidance grooves
	0,15 mm	Upper distance guidance groove tolerance
	-0,15 mm	Lower distance guidance groove tolerance
N	29 mm	Fixing bore

### Additional information

TUE10	Housing
GRAE50-XL-NPP-B	Bearing designation